



QX Series™

**QX**  
SERIES  
PRECISION FASTENING SYSTEMS



**REAL TOOLS FOR REAL WORK.™**

# Take Total Control

Taking total control of your fastening process doesn't have to be complicated. Our comprehensive QX Series™ family of fastening systems deliver simple, flexible and capable solutions for all of your assembly requirements. No matter the industry or application, you can count on Ingersoll Rand as a trusted partner to help you get the job done right.



QX Series™  
Precision  
Screwdriver

INSIGHTqcx™  
Cordless Controller



QX Series™ Angle Wrenches



QX Series™ Multiplier  
1,000 Nm Pistol

ETS\* product



## Simple

- Save on selection, training and installation costs
- Multi-function display module for quick setup and feedback
- Compact, lightweight and ergonomically balanced so the operator can work without restraints
- The intuitive INSIGHT Connect app will help you stay productive and mobile on the plant floor



## Flexible

- Custom solutions available
- Provides up to eight fully programmable configurations on a single tool, reducing costs and workspace clutter
- Fast and intuitive programming makes the tool easily adaptable to any needed changes on your assembly line
- Cordless and portable, allowing for effortless movement around your facility



## Capable

- At the heart of every tool is the closed-loop transducer control that delivers precise torque and accurate, traceable results
- Durable designs, lower cost of ownership
- Available in a variety of configurations, including pistol grip, angle wrench, multiplier and ETS\*
- Wireless communication option enables flexible line integration, remote monitoring and simple system programming across a plant-wide network
- Manage cycle data, control the process, receive system status alerts and implement configuration adjustments in real time using Ethernet, Fieldbus and digital I/O

## Icon identifiers

Compatibility Reference



USB compatible



Insight Connect App



Wireless



ICS

\* Ergonomic Tightening System

# QX Series™ Features



Patented transducer control provides traceable results

USB port for convenient programming and data transfer

Precision planetary gears for greater reliability

Stores cycle data for up to 1,200 rundowns

Multiple drive choices  
1/4" quick-change, 1/4" square drive, 3/8" square drive, and 1/2" square drive options available

Durable DC brushless motor tested beyond a million cycles

Super bright LED headlight with programmable on and off times. (Not available on the QX Series™ angle wrench)

Optional wireless communications for process control and data collection

High strength, impact resistant lens guards against damage

Non-contacting patented trigger and reverse switch for maximum durability

Ergonomic design, comfortable, lightweight and balanced

Digital signal processor monitors torque, angle and motor current while communicating end-of-run data



Optional backlit display offers quick setup and remarkable visual feedback

Lithium ion battery provides maximum run time and portability

- Simple
- Flexible
- Capable

# How to Select the Right Tool

When it comes to fastening, non-transducerized tools don't stand a chance. The QX Series™ line of products give you closed-loop control of your fastening process. Each and every tool allows for programmable tightening strategies to deliver higher quality fastened joints and a level of control that is unmatched by other solutions. The diversity of the QX Series™ lineup offers a simple, flexible and capable solution for any fastening need.

## FEATURES

|   | <br><b>QXN</b> | <br><b>QXC</b> | <br><b>QXX</b> |
|---|---|--|---|
| Total control of torque, speed and degrees of rotation  | ✓   | ✓  | ✓   |
| One tightening configuration that is programmed via USB using the INSIGHT Connect app               | ✓   |  |   |
| Eight tightening configurations available, giving it the ability to consolidate the number of tools |   | ✓  | ✓   |
| Programming capability via USB using ICS software   | ✓   | ✓  | ✓   |
| Optional ETS (Ergonomic Tightening System) to reduce torque reaction experienced by operator        | ✓   | ✓  | ✓   |
| Ability to program a multi-step tightening configuration  | ✓   | ✓  | ✓   |
| Multi-color visual status indicators for operator feedback  | ✓   | ✓  | ✓   |
| INSIGHT Connect app   | ✓   | ✓  | ✓   |
| Display shows actual achieved torque or angle value   |   | ✓  | ✓   |
| Programming capability using onboard keypad and display   |   | ✓  | ✓   |
| QXM Torque Multiplier (optional) models   |   | ✓  | ✓   |
| Ability to integrate with line control systems for error proofing and data collection               |   |  | ✓   |
| Compatible with standard accessories like light stack, socket tray, bar code scanner, etc           |   |  | ✓   |
| Allows remote access and programming via plant Ethernet network using ICS software                  |   |  | ✓   |



# QXN Cordless Tools

QXN offers superior transducerized control and operator feedback in a way that is easy to use and simple to setup. This unique series features one tightening configuration that can be programmed via USB using the INSIGHT Connect app.



## Features

- Transducerized for precise torque measurement
- Closed-loop control of torque, speed and degrees of rotation
- Programmable preventative maintenance alarms
- Maintenance indicator for troubleshooting and diagnostics
- One tightening configuration
- Simple to program via USB using the INSIGHT Connect app
- 1200 cycles of data storage – accessible via the INSIGHT Connect app
- Transducerized for precise torque measurement
- Visual operator feedback using green, yellow and red lights



See page 9 for more information  
Download the Insight Connect APP for free

# QXC Cordless Tools

The versatile QXC features eight tightening configurations, giving it the ability to consolidate the number of tools needed in your bag or at your bench. This series also enhances the feedback provided from the tool by displaying the measured torque or angle result to the operator.



**Eight in One**

## Features

- Transducerized for precise torque measurement
- Closed-loop control of torque, speed and degrees of rotation
- Programmable preventative maintenance alarms
- Maintenance indicator for troubleshooting and diagnostics
- Flexibility to utilize the same tool on multiple applications
- Visual torque validation on display
- Program eight configurations into one tool
- Simple to program options using the INSIGHT Connect app or back of tool programming
- 1200 cycles of data storage – accessible via ICS software
- Visual operator feedback using green, yellow and red lights



See page 9 for more information  
Download the Insight Connect APP for free

# QXX Cordless Tools

The easy to use QXX has the unique ability to integrate with line control systems for error proofing and data collection. The series also allows remote monitoring and integration with standard fastening system accessories.



## Eight in One

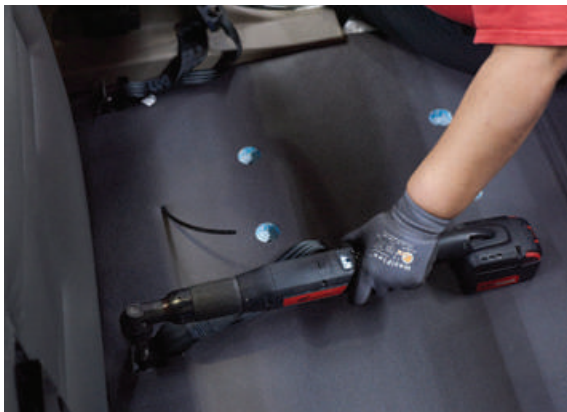

### Features

- Transducerized for precise torque measurement
- Closed-loop control of torque, speed and degrees of rotation
- Programmable preventative maintenance alarms
- Maintenance indicator for troubleshooting and diagnostics
- Flexibility to utilize the same tool on multiple applications
- Visual torque validation on display
- Program eight configurations into one tool
- Simple to program options using ICS software and USB cable or back of tool programming
- Visual operator feedback using display screen and green and red lights
- Full integration into plant-wide Ethernet network, for increased connectivity
- Remote access and integrated data collection capability
- Use of PCM enables transmission of tightening data and line control integration via Ethernet, Fieldbus or I/O



See page 9 for more information  
Download the Insight Connect APP for free

# QX Series™ ETS Cordless Tools



Ergonomic Tightening System

## All the capability of the QX platform, without the torque reaction

Reducing the torque reaction in your fastening process doesn't have to be complicated. Control and ergonomics, not compromise – that is what the QX ETS\* is all about. The QX ETS\* offers all the capabilities found in the QX Series™ platform, without the torque reaction.

### Features

- Ergonomically enhanced motor control algorithm significantly reduces the average force experienced by the operator during the tightening process
- Red tool highlights provide clear indication of ETS\* tool identity vs standard QX tool
- Continuously blue light above keypad provides operator assurance that ETS\* is ACTIVE
- QXN, QXC and QXX versions available



Simple



Flexible



Capable



USB compatible



Insight Connect App

ETS non active

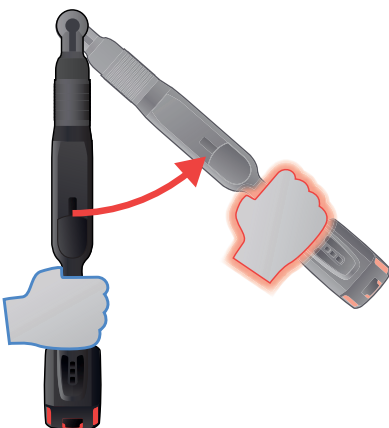

ETS active



### Simple Setup

In addition to standard direct drive mode, each tool configuration can be independently programmed to utilize one of the three available ETS\* modes, simplifying setup:

**Ergonomic Mode**, with the lowest energy pulses, is ideal for hard joints or when arm, wrist or tool angles are most difficult.

**Performance Mode**, with medium energy pulses, is the best all-purpose mode.

**Productivity Mode**, with the highest energy pulses, is the fastest mode. Ideal for soft joints or when high production rates are required.

**Standard QX Direct Drive Mode**, when disable the ETS\* Mode, this tools can be used as a QX standard drive mode.

\* Ergonomic Tightening System



# INSIGHT™ Connect App



The INSIGHT™ Connect app will help you stay productive, mobile and in control of your fastening process. It programs any QXN, QXC, QXX tool without the need for additional technical training, special software or a laptop computer. Working from a smartphone or tablet, operators can use the app to quickly program the torque and angle control configurations on these closed-loop, transducerized tools.

Once installed, the INSIGHT™ Connect app can operate offline, so it functions in large facilities or other locations where Internet signal loss may be a problem, reducing downtime and maximizing ease of use. You can quickly perform key tasks with your mobile device, including:

## Simple

- Common Setting & General Tool Setup
- Multiple Language Support
- Retrieve Cycle Log and Share via Email
- Audit Logs
- Error Codes with Description

## Flexible

- Program All Standard QX Platform Tool
- Clone- Back Up and Restore
- Save and Load Configurations
- Firmware Update

## Capable

- Program Torque, Angle, Speed
- Multiple Configurations (Upto 32)
- Multiple Step Programming
- End of Run (EOR) data on App
- Calibration and Cp/Cpk



## QXM Cordless Torque Multiplier

The innovative QX Series™ Cordless Torque Multiplier will reduce your fastening time and cost, while ensuring repeatable accuracy for all torque-critical joints. Designed with a premium gearbox and an efficient, time-tested closed-loop transducer, the Torque Multiplier is world-class in quality, control and programmable configurations to maximize your productivity.

### Features

- Maintenance indicator for troubleshooting and diagnostics
- A multi-function display module allowing for quick setup and feedback on every QX Series™ tool
- User-programmable parameters such as torque, angle and batch count reduce the number of tools needed when multiple applications are required
- Simple programming methods make the tool easily adaptable for various applications
- Pistol and angle configurations available



**Torque Range up to 2000 Nm**

For QXM Cordless Torque Multiplier reaction arms selection, please refer to Page 19

# Customize for Specialty Applications

## QX Pistol Special Head Adapter

The QX Pistol Special Head Adapter is the perfect solution to simply increase the flexibility of your QX pistol screwdriver. Using this adapter leverages the closed-loop capability of the QX tool to the most unique applications. The adapter helps manufacturers meet the requirements of applications where restricted access requires a custom head to reach the fastener. Common applications requiring a special head adapter, include assembling aircraft wings or installing door hinges on cars and trucks.



**SIMPLE**  
Ready made and easy to install



**FLEXIBLE**  
Use your QX pistol grip tool for unique applications



**CAPABLE**  
Employ closed-loop control capabilities on specialty applications



**TK-VP1-550-S6**  
Standard 3/8" Square Drive Anglehead

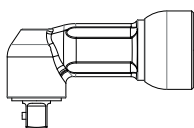

**TK-VP1-550-Q4**  
Standard 1/4" QC Drive Anglehead

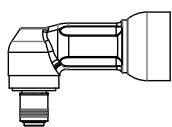

**TK-VP1-58**  
Standard 3/8" Square Drive Inline Floating Spindle with Flange Mount

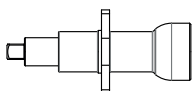

**Custom Attachment**  
Employ closed-loop control capabilities on specialty applications.

**VP1-K40**  
Special Head Adapter

Thrust washer  
Lock spacer

Any non-multiplier pistol grip QX tool

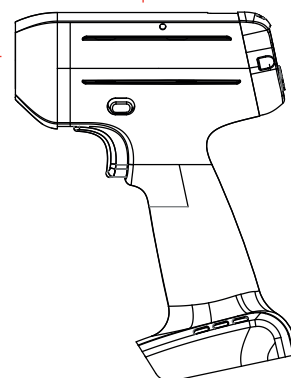

# A Cordless Network for Unlimited Productivity

## INSIGHTqcx™ Controller



When trying to achieve simple manufacturing goals in a complex manufacturing world, understanding the fastening process doesn't have to be complicated. The new Ingersoll Rand® INSIGHTqcx™ is different, by design. This cordless controller is designed to be easy to use and integrate, while providing a common platform to meet your assembly requirements worldwide.



**SIMPLE**

**EXPERTISE  
NOT  
REQUIRED**



**FLEXIBLE**

**EASILY  
IMPLEMENT  
CHANGE**



**CAPABLE**

**MEET YOUR  
REQUIREMENTS**

### WHAT DOES THIS MEAN TO ME?

- Save on selection, training and installation costs
- Reduce errors and downtime
- Remove user dependencies

- Reduce line rebalancing costs
- Easy line integration
- Remove device dependency

- Get the job right, every time
- Assurance via traceability
- Optimize your productivity

### HOW DOES INGERSOLL RAND PROVIDE VALUE?

- Intuitive, visual programming interface
- Plug and play accessories and protocols
- Integrated backup and recovery
- Bundled controller options

- Web based programming use any operating system via any browser
- Meets current industry communication needs
- Integrated logic controls
- Easy hardware and software upgrades
- Onboard wireless energy scan

- Touch screen interface
- Industry leading cycle data storage
- Robust audit and system logs
- Advanced tightening strategies and features
- Onboard diagnostics
- Integrated statistical process controls

## Simply Insightful

The controller's web-based software eliminates device dependencies and enables full programming capability with any device that can run an internet browser, including smart phones, tablets or computers. The INSIGHTqcx™ controller is easy to integrate with the manufacturing line, provides flexible logic controls for job sequencing and helps reduce line rebalancing costs through a simple and intuitive user interface.

# INSIGHTqcx™ Cordless Controller Features



Integrated wall mount



Configure up to 32 Psets



SSD card



Whiteboard & QR code



Holds 50,000 records

Integrated carrying handle



Power indicator



7-in full color touch screen



System indicators

- Factory connection
- Wireless connection
- Link status
- Fault detected



Ethernet ports 10/100/1000



USB 2.0 ports (4)



Fieldbus card slot

- Ethernet IP
- Profinet
- Profibus
- Devicenet
- Others



**SIMPLE**



**FLEXIBLE**



**CAPABLE**



# INSIGHTqcx™ Cordless Controller Models

The INSIGHTqcx™ Controller is 100% compatible with our QXX tools. With the INSIGHTqcx™, the controller can store 50K tightening records and 50K tightening traces– which will let users understand all facts of the tightening process – torque, angle, time and date.

| Model     | Display | Fieldbus Options |          |          |           |         | Mes Options     |               |      |                   |
|-----------|---------|------------------|----------|----------|-----------|---------|-----------------|---------------|------|-------------------|
|           |         | Ethernet I/P     | ProfiNET | ProfiBUS | DeviceNET | CC-Link | IR Ethernet EOR | Open Protocol | PFCS | Nissan Serial EOR |
| QCXD11    | YES     |                  |          |          |           |         | •               |               |      |                   |
| QCXD11-F  | YES     | •                | •        |          |           |         | •               |               |      |                   |
| QCXD11-M  | YES     |                  |          |          |           |         | •               | •             | •    | •                 |
| QCXD11-FM | YES     | •                | •        |          |           |         | •               | •             | •    | •                 |
| QCXD12-F  | YES     | •                | •        | •        |           |         | •               |               |      |                   |
| QCXD12-FM | YES     | •                | •        | •        |           |         | •               | •             | •    | •                 |
| QCXD13-F  | YES     | •                | •        |          | •         |         | •               |               |      |                   |
| QCXD13-FM | YES     | •                | •        |          | •         |         | •               | •             | •    | •                 |
| QCXD15-F  | YES     | •                | •        |          |           | •       | •               |               |      |                   |
| QCXD15-FM | YES     | •                | •        |          |           | •       | •               | •             | •    | •                 |
| QCXM11    | NO      |                  |          |          |           |         | •               |               |      |                   |
| QCXM11-F  | NO      | •                | •        |          |           |         | •               |               |      |                   |
| QCXM11-M  | NO      |                  |          |          |           |         | •               | •             | •    | •                 |
| QCXM11-FM | NO      | •                | •        |          |           |         | •               | •             | •    | •                 |
| QCXM12-F  | NO      | •                | •        | •        |           |         | •               |               |      |                   |
| QCXM12-FM | NO      | •                | •        | •        |           |         | •               | •             | •    | •                 |
| QCXM13-F  | NO      | •                | •        |          | •         |         | •               |               |      |                   |
| QCXM13-FM | NO      | •                | •        |          | •         |         | •               | •             | •    | •                 |
| QCXM15-F  | NO      | •                | •        |          |           | •       | •               |               |      |                   |
| QCXM15-FM | NO      | •                | •        |          |           | •       | •               | •             | •    | •                 |

## QX Series™ Process Communication Module (PCM)

|                                     |   |             |
|-------------------------------------|---|-------------|
| <b>Power Cord</b>                   | EU and UK cable   | IC-PCM-2-EU |
| <b>Tool Connections</b>             | Wireless tool connections (compatible with QXX)                                       | Up to 10    |
| <b>Software</b>                     | ICS Connect software  | •           |
| <b>Power Supply</b>                 | 100-240V AC input, 5V DC output   | •           |
| <b>Communication</b>                | Ethernet to ICS   | •           |
| <b>Fieldbus Options</b>             | Ethernet/IP, DeviceNet, Interbus-S, Profibus, Modbus-TCP                              | •           |
| <b>Protocols</b>                    | Open Protocol, Ethernet EOR, Serial EOR   | •           |
| <b>Printers/Devices</b>             | Serial RS232, bar code, label printing  | •           |
| <b>I/O</b>                          | 8 inputs/8 outputs, with behavior assignable through ICS software, operates at 24V DC | •           |
| <b>I/O Power Supply</b>             | 100-240V AC input, 24V DC output  | •           |
| <b>Indicators</b>                   | Power ON, System Ready, Wireless Activity, Ethernet Activity                          | •           |
| <b>Ambient Operating Conditions</b> | 0-50°C, 20/90% non-condensing humidity  | •           |
| <b>Enclosure</b>                    | IP52 mounted in upright vertical position   | •           |
| <b>System Weight</b>                | 1.4 kg  | •           |
| <b>Overall Dimensions</b>           | 291 mm x 103 mm x 210 mm  | •           |



Process Communication Module  
IC-PCM-2-EU

# INSIGHTqcx™ Cordless Controller Capabilities

| Software Capability             |          |   |   |    |                          |          |   |   |    |
|---------------------------------|----------|---|---|----|--------------------------|----------|---|---|----|
|                                 | Standard | F | M | FM |                          | Standard | F | M | FM |
| Embedded Software               | •        | • | • | •  | Factory Reset            | •        | • | • | •  |
| Home Screen                     | •        | • | • | •  | Network System Discovery | •        | • | • | •  |
| JOB Setup                       | •        | • | • | •  | License Update           | •        | • | • | •  |
| PSET Setup                      | •        | • | • | •  | License Activate         | •        | • | • | •  |
| Multiple Tightening Strategies  | •        | • | • | •  | Date & Time Settings     | •        | • | • | •  |
| Quick Programming               | •        | • | • | •  | System Initialization    | •        | • | • | •  |
| Advanced Programming            | •        | • | • | •  | IP Address Settings      | •        | • | • | •  |
| Cycle Results                   | •        | • | • | •  | Digital IO Settings      | •        | • | • | •  |
| JOB Results                     | •        | • | • | •  | EOR Data Out             | •        | • | • | •  |
| Audit Log                       | •        | • | • | •  | Barcode                  | •        | • | • | •  |
| Event Log                       | •        | • | • | •  | User Management          | •        | • | • | •  |
| System Diagnostics              | •        | • | • | •  | System Logs              | •        | • | • | •  |
| Tool Diagnostics                | •        | • | • | •  | Fieldbus Diagnostics     | •        | • | • | •  |
| Digital IO Diagnostics          | •        | • | • | •  | Fieldbus Settings        | •        | • | • | •  |
| Statistics Settings             | •        | • | • | •  | Ethernet IP              | •        | • | • | •  |
| Statistics Summary              | •        | • | • | •  | ProfiNet                 | •        | • | • | •  |
| Statistics Alarm Settings       | •        | • | • | •  | ProfiBus                 | •        | • | • | •  |
| Statistics Alarm Summary        | •        | • | • | •  | DeviceNet                | •        | • | • | •  |
| Backup and Restore              | •        | • | • | •  | MES Protocols Settings   | •        | • | • | •  |
| Firmware Update                 | •        | • | • | •  | Open Protocol            | •        | • | • | •  |
| Preventative Maintenance Alarms | •        | • | • | •  | ToolsNet                 | •        | • | • | •  |
| Tool Calibration                | •        | • | • | •  | VW XML 2.1               | •        | • | • | •  |

Torque/Angle Control

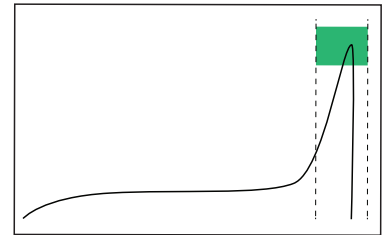

Prevailing Torque

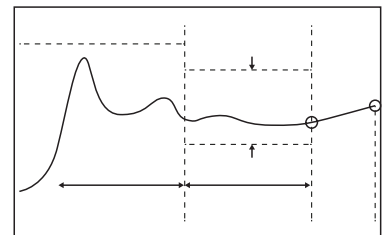

| Statistical Process Control     |  |
|---------------------------------|--|
| Statistic Status                | Description  |
| Mean                            | Statistical average - used to derive the central tendency of the tightening data of a particular PSET  |
| Capability                      | Calculated as $(6 * \sigma / \text{Mean}) * 100$ on a particular PSET  |
| Pass %                          | Indicates the % of the cycles that have a cycle result of PASS from the sample population of a particular PSET   |
| Fail %                          | Indicates the % of the cycles that have a cycle result of FAIL from the sample population of a particular PSET   |
| Mean Shift                      | Calculated as: $\text{MEAN Result Value} - \text{TARGET Result Value}$ for a particular PSET   |
| Range                           | Calculated as: $\text{MAX Result Value} - \text{MIN Result Value}$ of a particular PSET.   |
| Standard Deviation ( $\sigma$ ) | The calculated standard deviation ( $\sigma$ ) of the Result Value of a particular PSET.   |
| PP                              | Process Performance, calculated as: $(\text{USL} - \text{LSL}) / (6 * \sigma)$   |
| CAM                             | Calculated as: $(\text{USL} - \text{USL}) / (6 * (W / d * S))$   |
| PPK                             | Process Performance Index, Calculated as: $\text{MIN} ((\text{MEAN} - \text{LSL}) / (3 * \sigma)) \text{ OR } (\text{USL} - \text{MEAN}) / (3 * \sigma)$ |

# INSIGHTqcx™ Cordless Controller Specification

| Hardware  |   |
|---|---|
| Weight (Kg)   | 2.5   |
| Volume (dm3)  | 7.5   |
| Colour Touchscreen  | 7 inch  |
| Ethernet Port (10/100)  | 1   |
| Ethernet Port (10/100/1K)   | 1   |
| USB 2.0 Ports   | 4   |
| Boot Time (seconds)   | 40  |
| Voltage / Current Requirement   | 24V / 2A  |
| IP Rating (mounted vertically)  | IP52  |
| Software  |   |
| PC Software   | Not Required  |
| PC License  | Not Required  |
| Number of JOBS  | 256   |
| Number of PSETs (per JOB)   | 32  |
| Number of Steps (per PSET)  | 8   |
| Logic Rules for JOB Sequencing  | Y   |
| Barcode function: USB, Serial, Ethernet   | Y   |
| Manual Barcode Entry Option   | Y   |
| Tubeut Controls (Configurable modes)  | Y   |
| Number of Configurable User Logins  | Unlimited   |
| Quick Programming Mode  | Y   |
| Advanced Programming Mode   | Y   |
| Unrestricted programming function from controller screen  | Y   |
| Unrestricted remote programming from any device via any authorized browser                        | Y   |
| Embedded, Context-Specific Help *   | Y   |
| Email Statistics Alarms Direct From Controller**  | N   |
| Email Preventative Maintenance Alarms Direct from Controller                                      | N   |
| Multi-language Support  | Y   |
| Onboard Tool Diagnostics  | Y (when connected via USB)  |
| Wireless Energy Scan  | Y   |
| Easy Pairing  | Y   |
| Onboard Data Storage  |   |
| Removeable SSD Hard Drive that stores ALL settings and data                                       | Y   |
| Complete controller settings and data recovery through SSD swap                                   | Y   |
| Tightening Results  | 50,000  |
| Tightening Curve  | 50,000  |
| Tightening curve displayed on Home screen of controller   | Y   |
| Audit Log   | 50,000  |
| Event Log   | 50,000  |
| System Log  | 50,000  |
| Full Backup and Restore Function (USB or from computer/Tablet)                                    | Y   |
| Connectivity  |   |
| Fieldbus Options  | Ethernet IP, ProfiNet , ProfiBus, DeviceNet   |
| MES Protocol Options  | Open Protocol, Ford Open, PFCS, Toolsnet*** 3.2 & 8.0 , VW XML 2.0/ 2.1, IR Ethernet EOR, TOHO, |
| Supported Languages   |   |
| English, French, German, Italian, Spanish, Czech, Russian, Portuguese, Polish, Simplified Chinese |   |

\* Available from June 2020

\*\* Requires proper authorization and network settings by plant IT Administrator for each controller

\*\*\* No Trace Transfer

# System Accessories

We offer a wide range of accessories that offer ease of use and flexibility to meet your specific application needs. QX Precision Fastening Systems are compatible with a variety of plug and play accessories to maximize productivity for your manufacturing line.

## Accessories for Any Application

- Battery chargers
- Battery packs
- Boots
- Bit selector trays
- Socket selector trays
- Suspension bales
- Auxiliary handles
- Selector tray cables
- Torque testers
- Spring balancers
- Socket kits

## Batteries

All QX Series™ IQV20 tools are compatible with both the BL2022 and BL2012 batteries. The BL2022 is optimum for longer use applications while the BL2012 is ideal for tighter spaces and reduced weight. The QX Series™ IQV40 high torque tools utilize the BL4011 40V battery for increased torque and runtime.

IQV40 Series 40V, 2.5Ah  
Battery Charger  
BC1161-EU



IQV40 Series 40V, 2.5Ah  
Lithium Ion Battery Pack  
BL4011

IQV20 Series 20V  
Battery Charger  
BC1121-EU



IQV20 Series 20V, 5.0Ah  
Lithium Ion Battery Pack  
BL2022

IQV20 Series 20V, 2.5Ah  
Lithium Ion Battery Pack  
BL2012

## Accessories



Bit Selector Tray  
IC-BIT-8



Socket Tray  
QC-SKTR



Selector Tray Cables  
IC-10PIN-6M for IC-Socket-4  
IC-19PIN-5M for IC-Bit-8



Light Tower  
QC-TL-4



DIO Box  
QC-DIO-8CH



Auxiliary Handle  
VP1-A48



Pistol Tool Suspension  
Bale VP1-365



Bar Code Scanners  
QC-BC-SCAN-WL  
QC-BC-SCAN-1  
QC-BC-SCAN-2

## QX Pistol Protective Boots

| Boot Color | Open Back   | Closed Back    |
|------------|-------------|----------------|
| Red        | VP1-BOOT    | VP1-BOOT-NP    |
| Orange     | VP1-OR-BOOT | VP1-OR-BOOT-NP |
| Yellow     | VP1-YL-BOOT | VP1-YL-BOOT-NP |
| Green      | VP1-GN-BOOT | VP1-GN-BOOT-NP |
| Blue       | VP1-BL-BOOT | VP1-BL-BOOT-NP |
| Black      | VP1-BK-BOOT | VP1-BK-BOOT-NP |
| White      | VP1-WT-BOOT | VP1-WT-BOOT-NP |



2.5Ah BL2012  
Battery Boot



5.0Ah BL2010  
Battery Boot



VP1-Boot-NP  
Protective cover with closed back



Angle head sleeve

| Model                          | CCN         | Tool Compatibility |
|--------------------------------|-------------|--------------------|
| <b>Model extended boot</b>     |             |                    |
| VA1-R18-170                    | 47526045001 | 05P                |
| VA1-R25-170                    | 47526046001 | 10P, 15P           |
| GAA2-170                       | 80199557    | 18P, 20P           |
| GAA4-170                       | 80199052    | 27P, 30P, 35P      |
| GAA5-170                       | 80199656    | 40P, 80P           |
| <b>Model Angle head sleeve</b> |             |                    |
| GEA40-170                      | 80095847    | 18P, 20P           |
| GEA40-171                      | 80095888    | 27P, 30P, 35P      |
| GEA40-172                      | 80095409    | 40P, 80P           |



# Specification QX Series™



mm



rpm



kg



mm



mm



V



in



Communication

## QXN Cordless Tools

| QX Series™ Cordless Precision Screwdriver |         |       |      |       |           |     |      |               |
|---|---------|-------|------|-------|-----------|-----|------|---------------|
| QXN2PT04PQ4                               | 0.8–4   | 1,500 | 0.91 | 215.4 | 20.3–26.0 | 20V | 1/4" | Via USB Cable |
| QXN2PT04PS4                               | 0.8–4   | 1,500 | 0.91 | 208.3 | 20.3–26.0 | 20V | 1/4" | Via USB Cable |
| QXN2PT04PS6                               | 0.8–4   | 1,500 | 0.91 | 212.0 | 20.3–26.0 | 20V | 3/8" | Via USB Cable |
| QXN2PT08PQ4                               | 1.6–8   | 1,150 | 0.91 | 215.4 | 20.3–26.0 | 20V | 1/4" | Via USB Cable |
| QXN2PT08PS4                               | 1.6–8   | 1,150 | 0.91 | 208.3 | 20.3–26.0 | 20V | 1/4" | Via USB Cable |
| QXN2PT08PS6                               | 1.6–8   | 1,150 | 0.91 | 212.0 | 20.3–26.0 | 20V | 3/8" | Via USB Cable |
| QXN2PT12PQ4                               | 2.4–12  | 750   | 0.91 | 215.4 | 20.3–26.0 | 20V | 1/4" | Via USB Cable |
| QXN2PT12PS4                               | 2.4–12  | 750   | 0.91 | 208.3 | 20.3–26.0 | 20V | 1/4" | Via USB Cable |
| QXN2PT12PS6                               | 2.4–12  | 750   | 0.91 | 212.0 | 20.3–26.0 | 20V | 3/8" | Via USB Cable |
| QXN2PT18PQ4                               | 3.6–18  | 500   | 0.91 | 215.4 | 20.3–26.0 | 20V | 1/4" | Via USB Cable |
| QXN2PT18PS6                               | 3.6–18  | 500   | 0.91 | 212.0 | 20.3–26.0 | 20V | 3/8" | Via USB Cable |
| QX Series™ Angle Wrench                   |         |       |      |       |           |     |      |               |
| QXN2AT05PQ4                               | 1.0–5   | 1,213 | 1.14 | 552   | 9.2       | 20V | 1/4" | Via USB Cable |
| QXN2AT10PS6                               | 2.0–10  | 936   | 1.18 | 525   | 12.5      | 20V | 3/8" | Via USB Cable |
| QXN2AT15PS6                               | 3.0–15  | 600   | 1.18 | 525   | 12.5      | 20V | 3/8" | Via USB Cable |
| QXN2AT18PQ4                               | 3.6–18  | 500   | 1.27 | 542   | 13        | 20V | 1/4" | Via USB Cable |
| QXN2AT18PS6                               | 3.6–18  | 500   | 1.27 | 542   | 13        | 20V | 3/8" | Via USB Cable |
| QXN2AT27PS6                               | 5.4–27  | 330   | 1.68 | 552   | 17        | 20V | 3/8" | Via USB Cable |
| QX Series™ High Torque Angle Wrench       |         |       |      |       |           |     |      |               |
| QXN5AT20PS06                              | 4.0–20  | 1,045 | 2.04 | 577.7 | 13.1      | 40V | 3/8" | Via USB Cable |
| QXN5AT30PS06                              | 6.0–30  | 775   | 2.18 | 581.8 | 17.2      | 40V | 3/8" | Via USB Cable |
| QXN5AT30PS08                              | 6.0–30  | 775   | 2.18 | 581.8 | 17.2      | 40V | 1/2" | Via USB Cable |
| QXN5AT35PS06                              | 7.0–35  | 640   | 2.18 | 581.8 | 17.2      | 40V | 3/8" | Via USB Cable |
| QXN5AT35PS08                              | 7.0–35  | 640   | 2.18 | 581.8 | 17.2      | 40V | 1/2" | Via USB Cable |
| QXN5AT40PS08                              | 8.0–40  | 545   | 2.27 | 586.1 | 21.6      | 40V | 1/2" | Via USB Cable |
| QXN5AT80PS08                              | 12.0–80 | 375   | 2.27 | 586.1 | 21.6      | 40V | 1/2" | Via USB Cable |

## QXC Cordless Tools

| QX Series™ Cordless Precision Screwdriver |         |       |      |       |           |     |      |               |
|---|---------|-------|------|-------|-----------|-----|------|---------------|
| QXC2PT04PQ4                               | 0.8–4   | 1,500 | 0.91 | 215.4 | 20.3–26.0 | 20V | 1/4" | Via USB Cable |
| QXC2PT04PS4                               | 0.8–4   | 1,500 | 0.91 | 208.3 | 20.3–26.0 | 20V | 1/4" | Via USB Cable |
| QXC2PT04PS6                               | 0.8–4   | 1,500 | 0.91 | 212.0 | 20.3–26.0 | 20V | 3/8" | Via USB Cable |
| QXC2PT08PQ4                               | 1.6–8   | 1,150 | 0.91 | 215.4 | 20.3–26.0 | 20V | 1/4" | Via USB Cable |
| QXC2PT08PS4                               | 1.6–8   | 1,150 | 0.91 | 208.3 | 20.3–26.0 | 20V | 1/4" | Via USB Cable |
| QXC2PT08PS6                               | 1.6–8   | 1,150 | 0.91 | 212.0 | 20.3–26.0 | 20V | 3/8" | Via USB Cable |
| QXC2PT12PQ4                               | 2.4–12  | 750   | 0.91 | 215.4 | 20.3–26.0 | 20V | 1/4" | Via USB Cable |
| QXC2PT12PS4                               | 2.4–12  | 750   | 0.91 | 208.3 | 20.3–26.0 | 20V | 1/4" | Via USB Cable |
| QXC2PT12PS6                               | 2.4–12  | 750   | 0.91 | 212.0 | 20.3–26.0 | 20V | 3/8" | Via USB Cable |
| QXC2PT18PQ4                               | 3.6–18  | 500   | 0.91 | 215.4 | 20.3–26.0 | 20V | 1/4" | Via USB Cable |
| QXC2PT18PS6                               | 3.6–18  | 500   | 0.91 | 212.0 | 20.3–26.0 | 20V | 3/8" | Via USB Cable |
| QX Series™ Angle Wrench                   |         |       |      |       |           |     |      |               |
| QXC2AT05PQ4                               | 1.0–5   | 1,213 | 1.14 | 552   | 9.2       | 20V | 1/4" | Via USB Cable |
| QXC2AT10PS6                               | 2.0–10  | 936   | 1.18 | 525   | 12.5      | 20V | 3/8" | Via USB Cable |
| QXC2AT15PS6                               | 3.0–15  | 600   | 1.18 | 525   | 12.5      | 20V | 3/8" | Via USB Cable |
| QXC2AT18PQ4                               | 3.6–18  | 500   | 1.27 | 542   | 13        | 20V | 1/4" | Via USB Cable |
| QXC2AT18PS6                               | 3.6–18  | 500   | 1.27 | 542   | 13        | 20V | 3/8" | Via USB Cable |
| QXC2AT27PS6                               | 5.4–27  | 330   | 1.68 | 552   | 17        | 20V | 3/8" | Via USB Cable |
| QX Series™ High Torque Angle Wrench       |         |       |      |       |           |     |      |               |
| QXC5AT20PS06                              | 4.0–20  | 1,045 | 2.04 | 577.7 | 13.1      | 40V | 3/8" | Via USB Cable |
| QXC5AT30PS06                              | 6.0–30  | 775   | 2.18 | 581.8 | 17.2      | 40V | 3/8" | Via USB Cable |
| QXC5AT30PS08                              | 6.0–30  | 775   | 2.18 | 581.8 | 17.2      | 40V | 1/2" | Via USB Cable |
| QXC5AT35PS06                              | 7.0–35  | 640   | 2.18 | 581.8 | 17.2      | 40V | 3/8" | Via USB Cable |
| QXC5AT35PS08                              | 7.0–35  | 640   | 2.18 | 581.8 | 17.2      | 40V | 1/2" | Via USB Cable |
| QXC5AT40PS08                              | 8.0–40  | 545   | 2.27 | 586.1 | 21.6      | 40V | 1/2" | Via USB Cable |
| QXC5AT80PS08                              | 12.0–80 | 375   | 2.27 | 586.1 | 21.6      | 40V | 1/2" | Via USB Cable |

# Specification QX Series™



mm



rpm



kg



mm



mm



V



in



Communication

## QXX Cordless Tools

| QX Series™ Cordless Precision Screwdriver |        |       |      |       |      |     |      |                        |
|---|--------|-------|------|-------|------|-----|------|------------------------|
| QXX2PT04PQ4                               | 0.8–4  | 1,500 | 0.91 | 215.4 | 26.0 | 20V | 1/4" | Wireless enabled + USB |
| QXX2PT04PS4                               | 0.8–4  | 1,500 | 0.91 | 208.3 | 26.0 | 20V | 1/4" | Wireless enabled + USB |
| QXX2PT04PS6                               | 0.8–4  | 1,500 | 0.91 | 212.0 | 26.0 | 20V | 3/8" | Wireless enabled + USB |
| QXX2PT08PQ4                               | 1.6–8  | 1,150 | 0.91 | 215.4 | 26.0 | 20V | 1/4" | Wireless enabled + USB |
| QXX2PT048S4                               | 1.6–8  | 1,150 | 0.91 | 208.3 | 26.0 | 20V | 1/4" | Wireless enabled + USB |
| QXX2PT08PS6                               | 1.6–8  | 1,150 | 0.91 | 212.0 | 26.0 | 20V | 3/8" | Wireless enabled + USB |
| QXX2PT12PQ4                               | 2.4–12 | 750   | 0.91 | 215.4 | 26.0 | 20V | 1/4" | Wireless enabled + USB |
| QXX2PT12PS4                               | 2.4–12 | 750   | 0.91 | 208.3 | 26.0 | 20V | 1/4" | Wireless enabled + USB |
| QXX2PT12PS6                               | 2.4–12 | 750   | 0.91 | 212.0 | 26.0 | 20V | 3/8" | Wireless enabled + USB |
| QXX2PT18PQ4                               | 3.6–18 | 500   | 0.91 | 215.4 | 26.0 | 20V | 1/4" | Wireless enabled + USB |
| QXX2PT18PS6                               | 3.6–18 | 500   | 0.91 | 212.0 | 26.0 | 20V | 3/8" | Wireless enabled + USB |

| QX Series™ Angle Wrench |        |       |      |     |      |     |      |                        |
|-------------------------|--------|-------|------|-----|------|-----|------|------------------------|
| QXX2AT05PQ4             | 1.0–5  | 1,213 | 1.14 | 552 | 9.2  | 20V | 1/4" | Wireless enabled + USB |
| QXX2AT10PS6             | 2.0–10 | 936   | 1.18 | 525 | 12.5 | 20V | 3/8" | Wireless enabled + USB |
| QXX2AT15PS6             | 3.0–15 | 600   | 1.18 | 525 | 12.5 | 20V | 3/8" | Wireless enabled + USB |
| QXX2AT18PQ4             | 3.6–18 | 500   | 1.27 | 542 | 13   | 20V | 1/4" | Wireless enabled + USB |
| QXX2AT18PS6             | 3.6–18 | 500   | 1.27 | 542 | 13   | 20V | 3/8" | Wireless enabled + USB |
| QXX2AT27PS6             | 5.4–27 | 330   | 1.68 | 552 | 17   | 20V | 3/8" | Wireless enabled + USB |

| QX Series™ High Torque Angle Wrench |         |       |      |       |      |     |      |                        |
|-------------------------------------|---------|-------|------|-------|------|-----|------|------------------------|
| QXX5AT20PS06                        | 4.0–20  | 1,045 | 2.04 | 577.7 | 13.1 | 40V | 3/8" | Wireless enabled + USB |
| QXX5AT30PS06                        | 6.0–30  | 775   | 2.18 | 581.8 | 17.2 | 40V | 3/8" | Wireless enabled + USB |
| QXX5AT30PS08                        | 6.0–30  | 775   | 2.18 | 581.8 | 17.2 | 40V | 1/2" | Wireless enabled + USB |
| QXX5AT35PS06                        | 7.0–35  | 640   | 2.18 | 581.8 | 17.2 | 40V | 3/8" | Wireless enabled + USB |
| QXX5AT35PS08                        | 7.0–35  | 640   | 2.18 | 581.8 | 17.2 | 40V | 1/2" | Wireless enabled + USB |
| QXX5AT40PS08                        | 8.0–40  | 545   | 2.27 | 586.1 | 21.6 | 40V | 1/2" | Wireless enabled + USB |
| QXX5AT80PS08                        | 12.0–80 | 375   | 2.27 | 586.1 | 21.6 | 40V | 1/2" | Wireless enabled + USB |

## QXM Cordless Torque Multiplier

| QX Series™ Pistol |           |    |      |     |    |     |      |                        |
|-------------------|-----------|----|------|-----|----|-----|------|------------------------|
| QXC2PT200NPS12    | 40–200    | 45 | 3.62 | 373 | 56 | 20V | 3/4" | Via USB Cable          |
| QXC2PT500NPS12    | 100–500   | 18 | 3.62 | 373 | 56 | 20V | 3/4" | Via USB Cable          |
| QXC2PT1000NPS12   | 200–1,000 | 9  | 5.44 | 419 | 80 | 20V | 3/4" | Via USB Cable          |
| QXC2PT1350NPS16   | 270–1,350 | 7  | 5.44 | 419 | 80 | 20V | 1"   | Via USB Cable          |
| QXC2PT2000NPS16   | 400–2,000 | 5  | 6.80 | 452 | 80 | 20V | 1"   | Via USB Cable          |
| QXX2PT200NPS12    | 40–200    | 45 | 3.62 | 373 | 56 | 20V | 3/4" | Wireless enabled + USB |
| QXX2PT500NPS12    | 100–500   | 18 | 3.62 | 373 | 56 | 20V | 3/4" | Wireless enabled + USB |
| QXX2PT1000NPS12   | 200–1,000 | 9  | 5.44 | 419 | 80 | 20V | 3/4" | Wireless enabled + USB |
| QXX2PT1350NPS16   | 270–1,350 | 7  | 5.44 | 419 | 80 | 20V | 1"   | Wireless enabled + USB |
| QXX2PT2000NPS16   | 400–2,000 | 5  | 6.80 | 452 | 80 | 20V | 1"   | Wireless enabled + USB |

| QX Series™ Pistol Kit* |           |    |      |     |    |     |      |                        |
|------------------------|-----------|----|------|-----|----|-----|------|------------------------|
| QXC2P200S12K2          | 40–200    | 45 | 3.62 | 373 | 56 | 20V | 3/4" | Via USB Cable          |
| QXC2P500S12K2          | 100–500   | 18 | 3.62 | 373 | 56 | 20V | 3/4" | Via USB Cable          |
| QXC2P1000S12K2         | 200–1,000 | 9  | 5.44 | 419 | 80 | 20V | 3/4" | Via USB Cable          |
| QXC2P1350S16K2         | 270–1,350 | 7  | 5.44 | 419 | 80 | 20V | 1"   | Via USB Cable          |
| QXC2P2000S16K2         | 400–2,000 | 5  | 6.80 | 452 | 80 | 20V | 1"   | Via USB Cable          |
| QXX2P200PS12K2         | 40–200    | 45 | 3.62 | 373 | 56 | 20V | 3/4" | Wireless enabled + USB |
| QXX2P500PS12K2         | 100–500   | 18 | 3.62 | 373 | 56 | 20V | 3/4" | Wireless enabled + USB |
| QXX2P1000PS12K2        | 200–1,000 | 9  | 5.44 | 419 | 80 | 20V | 3/4" | Wireless enabled + USB |
| QXX2P1350PS16K2        | 270–1,350 | 7  | 5.44 | 419 | 80 | 20V | 1"   | Wireless enabled + USB |
| QXX2P2000PS16K2        | 400–2,000 | 5  | 6.80 | 452 | 80 | 20V | 1"   | Wireless enabled + USB |

| QX Series™ Angle Wrench* |           |     |      |     |     |     |      |                        |
|--------------------------|-----------|-----|------|-----|-----|-----|------|------------------------|
| QXX5A45T0180PS12         | 16–180    | 110 | 4.25 | 560 | 150 | 40V | 3/4" | Wireless enabled + USB |
| QXX5A45T0270PS12         | 54–270    | 77  | 4.25 | 560 | 150 | 40V | 3/4" | Wireless enabled + USB |
| QXX2A52T0396PS12         | 79–395    | 21  | 3.54 | 535 | 175 | 20V | 3/4" | Wireless enabled + USB |
| QXX2A52T0594PS12         | 119–594   | 14  | 4.06 | 535 | 175 | 20V | 3/4" | Wireless enabled + USB |
| QXX5A52T0880PS12         | 180–880   | 23  | 4.60 | 560 | 175 | 40V | 3/4" | Wireless enabled + USB |
| QXX5A72T1080PS16         | 216–1,080 | 19  | 5.97 | 575 | 195 | 40V | 1"   | Wireless enabled + USB |
| QXX5A72T1620PS16         | 324–1,620 | 13  | 5.97 | 575 | 195 | 40V | 1"   | Wireless enabled + USB |

# Specification QX Series™



Nm



rpm



kg



mm



mm



V



in



Communication

## QX ETS Cordless Tools (Ergonomic Tightening System)

| QXN Cordless Precision Screwdriver    |         |       |      |       |      |            |                   |                        |
|---------------------------------------|---------|-------|------|-------|------|------------|-------------------|------------------------|
| QXN2PT08ES6                           | 1.6-8   | 1,150 | 0.91 | 203   | 26   | 20V Li-ion | 3/8" Square       | Via USB Cable          |
| QXN2PT08EQ4                           | 1.6-8   | 1,150 | 0.91 | 206.5 | 26   | 20V Li-ion | 1/4" Quick Change | Via USB Cable          |
| QXN2PT12ES6                           | 2.4-12  | 750   | 0.91 | 203   | 26   | 20V Li-ion | 3/8" Square       | Via USB Cable          |
| QXN2PT12EQ4                           | 2.4-12  | 750   | 0.91 | 206.5 | 26   | 20V Li-ion | 1/4" Quick Change | Via USB Cable          |
| QXN2PT18ES6                           | 3.6-18  | 500   | 0.91 | 203   | 26   | 20V Li-ion | 3/8" Square       | Via USB Cable          |
| QXN2PT18EQ4                           | 3.6-18  | 500   | 0.91 | 206.5 | 26   | 20V Li-ion | 1/4" Quick Change | Via USB Cable          |
| QXN2PT24ES6                           | 4.8-24  | 500   | 0.91 | 212   | 26   | 20V Li-ion | 3/8" Square       | Via USB Cable          |
| QXN Cordless Angle Wrench             |         |       |      |       |      |            |                   |                        |
| QXN2AT27ES6                           | 5.4-27  | 330   | 1.68 | 552   | 17.2 | 20V Li-ion | 3/8" Square       | Via USB Cable          |
| QXN Cordless High Torque Angle Wrench |         |       |      |       |      |            |                   |                        |
| QXN5AT40ES08                          | 8.0-40  | 545   | 2.27 | 586.1 | 21.6 | 40V Li-ion | 1/2" Square       | Via USB Cable          |
| QXN5AT80ES08                          | 12.0-80 | 375   | 2.27 | 586.1 | 21.6 | 40V Li-ion | 1/2" Square       | Via USB Cable          |
| QXC Cordless Precision Screwdriver    |         |       |      |       |      |            |                   |                        |
| QXC2PT08ES6                           | 1.6-8   | 1,150 | 0.91 | 203   | 26   | 20V Li-ion | 3/8" Square       | Via USB Cable          |
| QXC2PT08EQ4                           | 1.6-8   | 1,150 | 0.91 | 206.5 | 26   | 20V Li-ion | 1/4" Quick Change | Via USB Cable          |
| QXC2PT12ES6                           | 2.4-12  | 750   | 0.91 | 203   | 26   | 20V Li-ion | 3/8" Square       | Via USB Cable          |
| QXC2PT12EQ4                           | 2.4-12  | 750   | 0.91 | 206.5 | 26   | 20V Li-ion | 1/4" Quick Change | Via USB Cable          |
| QXC2PT18ES6                           | 3.6-18  | 500   | 0.91 | 203   | 26   | 20V Li-ion | 3/8" Square       | Via USB Cable          |
| QXC2PT18EQ4                           | 3.6-18  | 500   | 0.91 | 206.5 | 26   | 20V Li-ion | 1/4" Quick Change | Via USB Cable          |
| QXC2PT24ES6                           | 4.8-24  | 500   | 0.91 | 212   | 26   | 20V Li-ion | 3/8" Square       | Via USB Cable          |
| QXC Cordless Angle Wrench             |         |       |      |       |      |            |                   |                        |
| QXC2AT27ES6                           | 5.4-27  | 330   | 1.68 | 552   | 17.2 | 20V Li-ion | 3/8" Square       | Via USB Cable          |
| QXC Cordless High Torque Angle Wrench |         |       |      |       |      |            |                   |                        |
| QXC5AT40ES08                          | 8.0-40  | 545   | 2.27 | 586.1 | 21.6 | 40V Li-ion | 1/2" Square       | Via USB Cable          |
| QXC5AT80ES08                          | 12.0-80 | 375   | 2.27 | 586.1 | 21.6 | 40V Li-ion | 1/2" Square       | Via USB Cable          |
| QXX Cordless Precision Screwdriver    |         |       |      |       |      |            |                   |                        |
| QXX2PT08ES6                           | 1.6-8   | 1,150 | 0.91 | 203   | 26   | 20V Li-ion | 3/8" Square       | Wireless Enabled + USB |
| QXX2PT08EQ4                           | 1.6-8   | 1,150 | 0.91 | 206.5 | 26   | 20V Li-ion | 1/4" Quick Change | Wireless Enabled + USB |
| QXX2PT12ES6                           | 2.4-12  | 750   | 0.91 | 203   | 26   | 20V Li-ion | 3/8" Square       | Wireless Enabled + USB |
| QXX2PT12EQ4                           | 2.4-12  | 750   | 0.91 | 206.5 | 26   | 20V Li-ion | 1/4" Quick Change | Wireless Enabled + USB |
| QXX2PT18ES6                           | 3.6-18  | 500   | 0.91 | 203   | 26   | 20V Li-ion | 3/8" Square       | Wireless Enabled + USB |
| QXX2PT18EQ4                           | 3.6-18  | 500   | 0.91 | 206.5 | 26   | 20V Li-ion | 1/4" Quick Change | Wireless Enabled + USB |
| QXX2PT24ES6                           | 4.8-24  | 500   | 0.91 | 212   | 26   | 20V Li-ion | 3/8" Square       | Wireless Enabled + USB |
| QXX Cordless Angle Wrench             |         |       |      |       |      |            |                   |                        |
| QXX2AT27ES6                           | 5.4-27  | 330   | 1.68 | 552   | 17.2 | 20V Li-ion | 3/8" Square       | Wireless Enabled + USB |
| QXX Cordless High Torque Angle Wrench |         |       |      |       |      |            |                   |                        |
| QXX5AT40ES08                          | 8.0-40  | 545   | 2.27 | 586.1 | 21.6 | 40V Li-ion | 1/2" Square       | Wireless Enabled + USB |
| QXX5AT80ES08                          | 12.0-80 | 375   | 2.27 | 586.1 | 21.6 | 40V Li-ion | 1/2" Square       | Wireless Enabled + USB |

## QX Multiplier Reaction Arms

Ingersoll Rand offers the following variety of reaction arms for different applications. Reaction arms are available in both 52 mm and 72 mm spline drives, depending on the size of the gearbox.

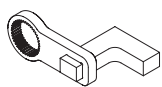

Cranked, 45 or 90 degrees

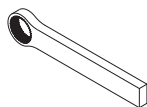

Straight, aluminum or steel (multiple lengths available)

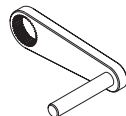
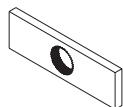
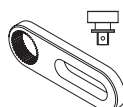

Plate and pin (multiple lengths available)



Double-sided



Sliding slave kit (multiple lengths available)

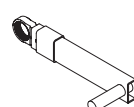

Sliding peg and yoke assembly (multiple lengths available)

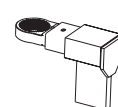

Sliding yoke, paddle and yoke assembly (multiple lengths available)



Blank welding ring



Ingersoll Rand (NYSE:IR), driven by an entrepreneurial spirit and ownership mindset, is committed to helping make life better. We provide innovative and mission-critical industrial, energy, medical and specialty vehicle products and services across 40+ respected brands designed to excel in even the most complex and harsh conditions where downtime is especially costly. Our employees connect to customers for life by delivering proven expertise, productivity and efficiency improvements. For more information, visit [www.IRCO.com](http://www.IRCO.com).

Distributed by:

Ingersoll Rand, IR and the IR logo are trademarks of Ingersoll Rand, its subsidiaries and/or affiliates. All other trademarks are the property of their respective owners. Nothing contained on these pages is intended to extend any warranty or representation, expressed or implied, regarding the product described herein. Any such warranties or other terms and conditions of sale of products shall be in accordance with Ingersoll Rand's standard terms and conditions of sale for such products, which are available upon request.

Product improvement is a continuing goal at Ingersoll Rand. Designs and specifications are subject to change without notice or obligation.